

**PNEUMATIC CYLINDERS, STANDARD VDMA - ISO 15552
CILINDRI PNEUMATICI, VDMA - ISO 15552**

SERIE XJC

CILINDRI PNEUMATICI PNEUMATIC CYLINDERS

With magnetic piston / Con pistone magnetico

XJC /

Bore / Alesaggio (mm):
 Ø160 **160**
 Ø200 **200**
 Ø250 **250**
 Ø320 **320**

Stroke
 Corsa (mm):

- VS** Viton rod seal
Guarnizione dello stelo in Viton
- VV** Viton all seal
Tutte le guarnizioni in Viton
- TN2** Multi-thrust tandem (Ø160 - Ø200)
Tandem multispinta (Ø160 - Ø200)
- SS** Stainless Steel X5 Cr Ni 18-10 piston-rod
Stelo in Acciaio Inox X5 Cr Ni 18-10

Through rod cylinder **P**
 Cilindro stelo passante

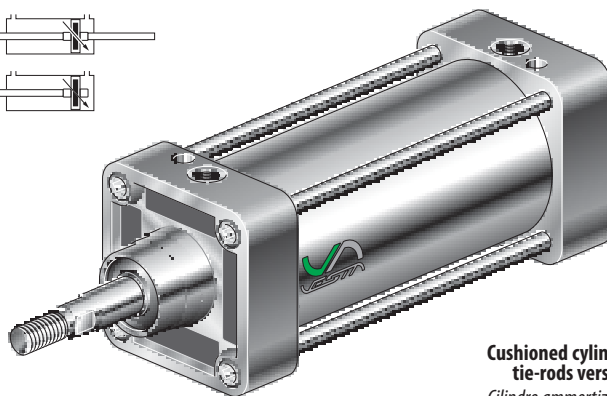
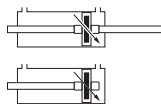

Cushioned cylinder, tie-rods version.
 Cilindro ammortizzato, esecuzione a tiranti.

ISO 15552 cylinder fixing see:
 Fissaggi per cilindri ISO 15552 vedi:
 **Pag. A-22 ÷ A-26**

Features of reed switches see:
 Caratteristiche finecorsa magnetici:
 **Pag. A-26**

Effective cushion length Lunghezza utile ammortizzatore	
Bore Alesaggio	Length Lunghezza
160	45
200	45
250	45
320	45

Bore Alesaggio	Standard stroke / Corse Standard																	
	25	50	80	100	125	160	200	250	300	350	400	450	500	600	700	800	900	1000
160
200
250
320

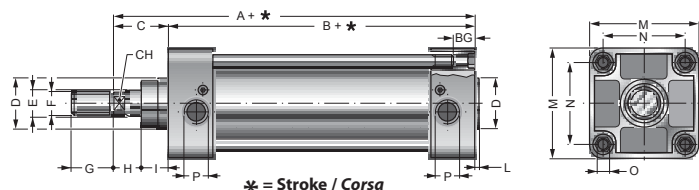

* = Stroke / Corsa

Bore Alesaggio	A	B	C	ØD	ØE	ØF	G	H	I	L	M	N	ØO	ØP	BG	CH	Code Codice
160	260	180	80	65	40	M36x2	72	35	45	5	180	140	M16	G3/4	22	36	XJC 160/...
200	275	180	95	75	40	M36x2	72	50	45	5	220	175	M16	G3/4	22	36	XJC 200/...
250	305	200	105	90	50	M42x2	84	30	75	8	270	220	M20	G1	25	46	XJC 250/...
320	340	220	120	110	63	M48x2	96	30	90	10	350	270	M24	G1	28	55	XJC 320/...

SINGLE ROD
 CILINDRO BASE STELO SEMPLICE **XJC ... / ...**

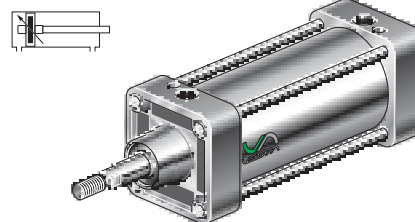

* On request / a richiesta : F = M24x2, e G = 48.

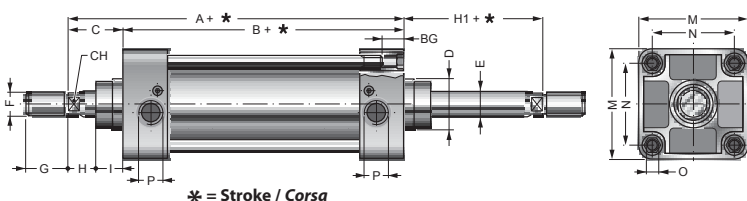

* = Stroke / Corsa

Bore Alesaggio	A	B	C	ØD	ØE	ØF	G	H	H1	I	M	N	ØO	ØP	BG	CH	Code Codice
160	260	180	80	65	40	M36x2	72	35	80	45	180	140	M16	G3/4	22	36	XJC 160/... P
200	275	180	95	75	40	M36x2	72	50	95	45	220	175	M16	G3/4	22	36	XJC 200/... P
250	305	200	105	90	50	M42x2	84	30	105	75	270	220	M20	G1	25	46	XJC 250/... P
320	340	220	120	110	63	M48x2	96	30	120	90	350	270	M24	G1	28	55	XJC 320/... P

THROUGH ROD
 STELO PASSANTE **XJC ... / ... P**

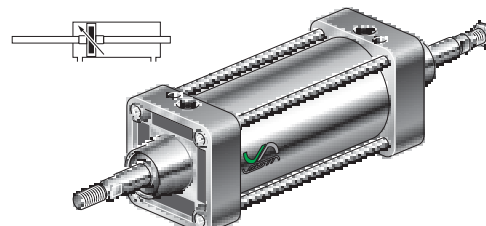

* On request / a richiesta : F = M24x2, e G = 48.

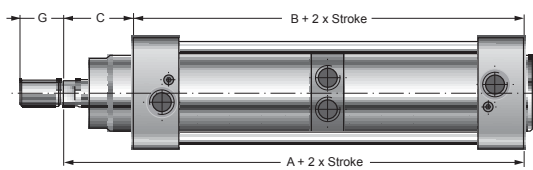

Bore Alesaggio	A	B	C	G	Code Codice
160	356	276	80	72	XJC 160/... TN...
200	395	300	95	72	XJC 200/... TN...

For other dimensions please see
XJC standard cylinder
 Per altre dimensioni vedere
 cilindri **XJC** standard

MULTI-THRUST TANDEM
 TANDEM MULTISPINTA **XJC ... TN2 ...**

